

Pulegge dentate per bussola conica
Timing belt pulleys for taper bushes
Zahnriemenscheiben für Spannbüchsen
Poulies dentées à moyeu amovible
Poleas dentadas para
casquillos cónicos (taper)

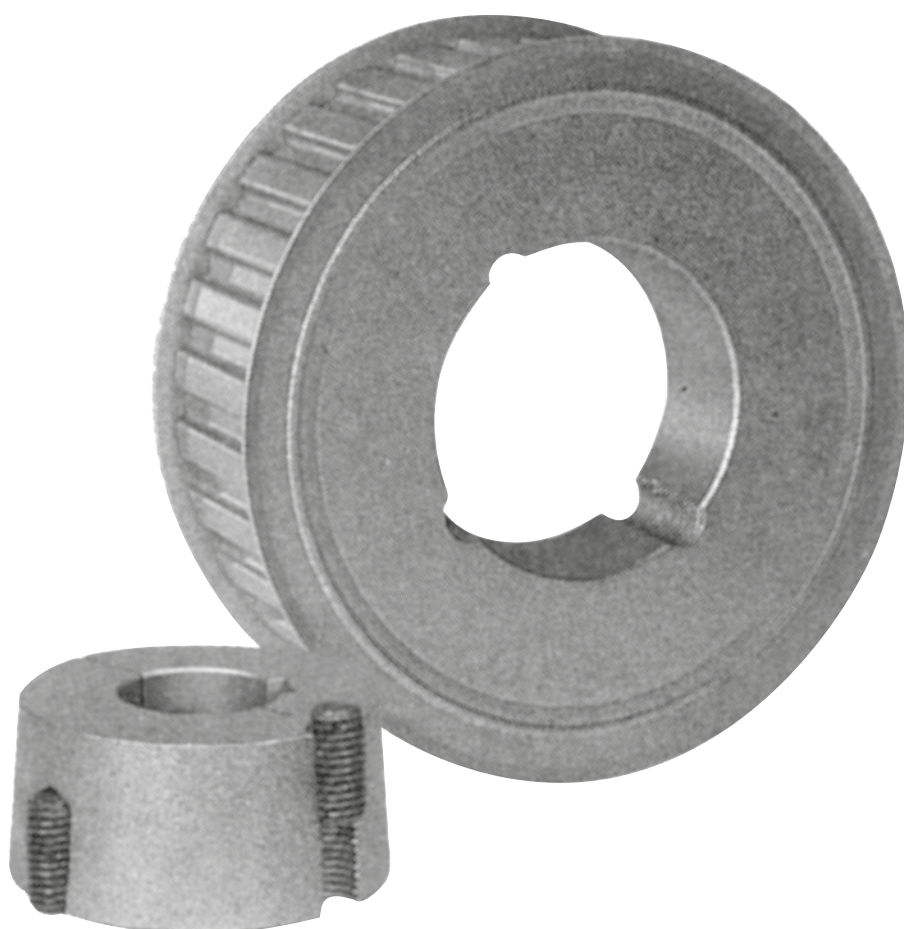

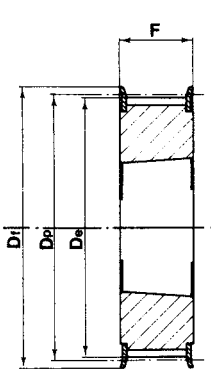

Tipo / Type
3F

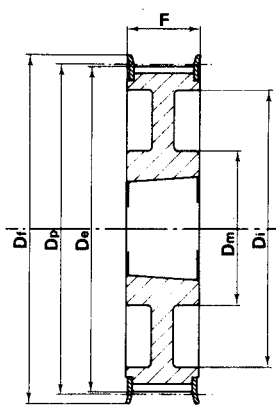

Tipo / Type
3WF

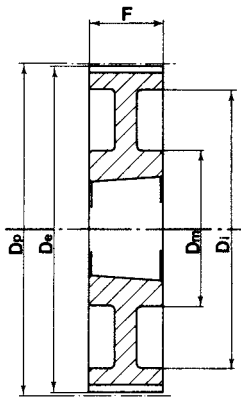

Tipo / Type
3W

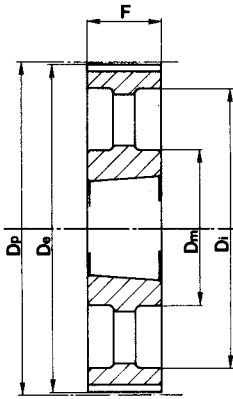

Tipo / Type
3A

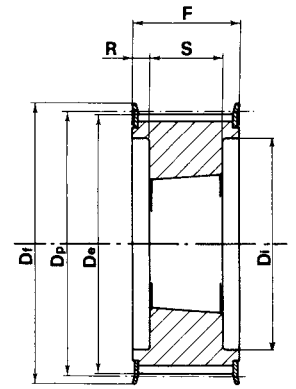

Tipo / Type
4F

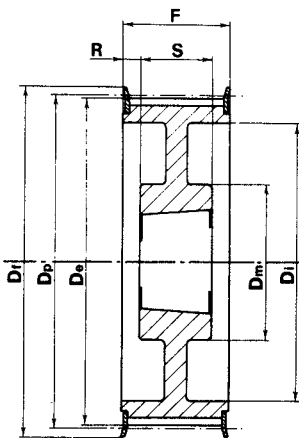

Tipo / Type
4WF

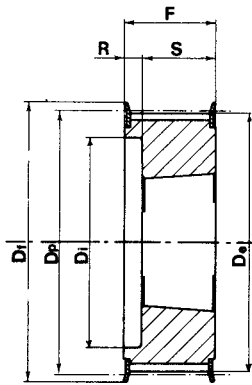

Tipo / Type
5F

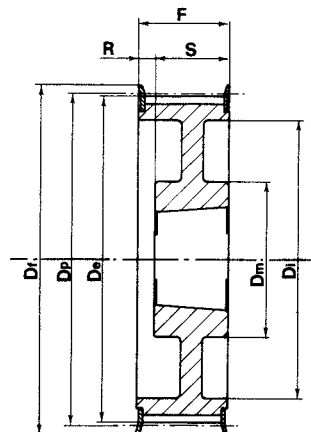

Tipo / Type
5WF

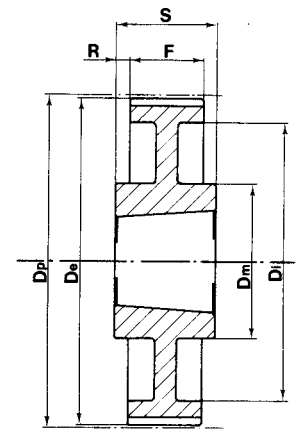

Tipo / Type
7W

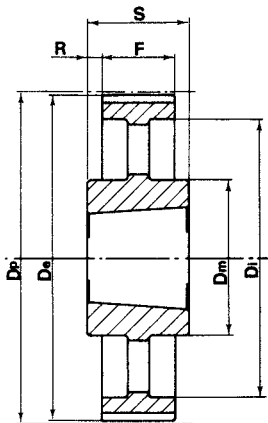

Tipo / Type
7A

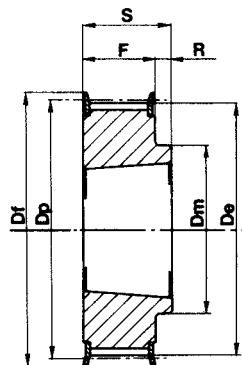

Tipo / Type
8F

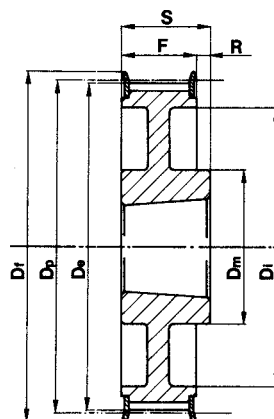

Tipo / Type
8WF

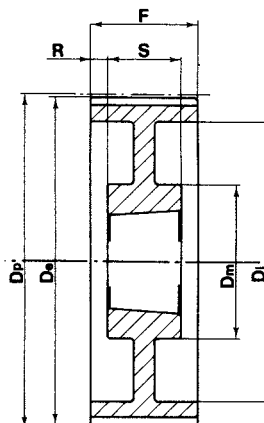

Tipo / Type
9W

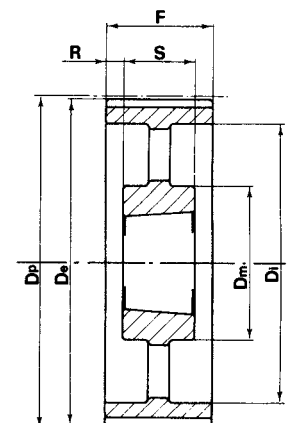

Tipo / Type
9A

Pulegge dentate per bussola conica / Timing belt pulleys for taper bushes
Zahnriemenscheiben für Spannbüchsen / Poulies dentées à moyeu amovible
Poleas dentadas para casquillos cónicos (taper)



L 050 - 3/8" (9,525 mm)

Caratteristiche Features Merkmale Características	Codice Code symbol Fabriknummer Code symbole Numero de fabrica	Nostro codice Our code Unser kode Notre code Nuestro codigo	Tipo Type Typ Type Tipo	Tipo flangia Flanges type Bordscheiben Typ Type flasques Tipo tapetas	Bussola Bush Buchse Moyeu Casquillo	Foro max. Max. Bore Max. Bohrung Alesage max. Agujero max.	Dp	De	Df	Dm	Di	F	S	R	Peso Weight / Gewicht Poids / Peso Kg
Acciaio / Steel / Stahl Acier / Acero	18L050	TL50018	8F	F22	1108	28	54,57	53,81	60	45	-	19,0	22,0	3	0,2
	19L050	TL50019	8F	F24	1108	28	57,61	56,84	64	45	-	19,0	22,0	3	0,2
	20L050	TL50020	8F	F25	1108	28	60,64	59,88	66	48	-	19,0	22,0	3	0,2
	21L050	TL50021	8F	F26	1108	28	63,67	62,91	70	48	-	19,0	22,0	3	0,3
	22L050	TL50022	8F	F27	1108	28	66,70	65,94	75	51	-	19,0	22,0	3	0,3
	23L050	TL50023	8F	F28	1108	28	69,73	68,97	79	54	-	19,0	22,0	3	0,4
	24L050	TL50024	8F	F28	1108	28	72,77	72,00	79	54	-	19,0	22,0	3	0,4
	25L050	TL50025	8F	F29	1108	28	75,80	75,04	83	56	-	19,0	22,0	3	0,5
	26L050	TL50026	8F	F30	1108	28	78,83	78,07	87	60	-	19,0	22,0	3	0,5
	27L050	TL50027	8F	F30	1108	28	81,86	81,10	87	62	-	19,0	22,0	3	0,6
	28L050	TL50028	8F	F31	1108	28	84,89	84,13	91	65	-	19,0	22,0	3	0,6
	30L050	TL50030	8F	F33	1108	28	90,96	90,20	97	70	-	19,0	22,0	3	0,8
	32L050	TL50032	8F	F34	1108	28	97,02	96,26	102	74	-	19,0	22,0	3	0,9
	36L050	TL50036	8F	F37	1108	28	109,15	108,39	115	85	-	19,0	22,0	3	1,2
	40L050	TL50040	8F	F40	1610	42	121,28	120,51	128	88	-	19,0	25,0	3	1,5
44L050	TL50044	8WF	F45	1610	42	133,40	132,64	142	88	110	19,0	25,0	6	1,8	
48L050	TL50048	8WF	F48	1610	42	145,53	144,77	150	88	120	19,0	25,0	6	2,3	
Ghisa / Cast iron Grauguss / Fonte Hierro fundido	60L050	TL50060	7W		1610	42	181,91	181,15	-	92	166	19,0	25,0	6	2,0
	72L050	TL50072	7A		1610	42	218,30	217,53	-	92	202	19,0	25,0	6	3,0
	84L050	TL50084	7A		1610	42	254,68	253,90	-	92	236	19,0	25,0	6	4,0
	96L050	TL50096	7A		2012	50	291,06	290,30	-	106	270	19,0	32,0	13	5,5
	120L050	TL50120	7A		2012	50	363,83	363,07	-	106	343	19,0	32,0	13	6,8

Pulegge dentate per bussola conica / Timing belt pulleys for taper bushes
Zahnriemenscheiben für Spannbüchsen / Poulies dentées à moyeu amovible
Poleas dentadas para casquillos cónicos (taper)

L 075 - 3/8" (9,525 mm)

Caratteristiche Features Merkmale Características	Codice Code symbol Fabriknummer Code symbole Numero de fabrica	Nostro codice Our code Unser kode Notre code Nuestro codigito	Tipo Type Typ Type Tipo	Tipo flangia Flanges type Bordscheiben Typ Type flasques Tipo tapetas	Bussola Bush Buchse Moyeu Casquillo	Foro max. Max. Bore Max. Bohrung Alesage max. Agujero max.	Dp	De	Df	Dm	Di	F	S	R	Peso Weight / Gewicht Poids / Peso Kg	
Acciaio / Steel / Stahl Acier / Acero	con flangia / with flanges mit Flanges / avec flasques / con tapetas	18L075	TL75018	3F	F22	1108	28	54,57	53,81	60	-	25,0	25,0	-	0,2	
		19L075	TL75019	3F	F24	1108	28	57,61	56,84	64	-	25,0	25,0	-	0,3	
		20L075	TL75020	3F	F25	1108	28	60,64	59,88	66	-	25,0	25,0	-	0,3	
		21L075	TL75021	3F	F26	1108	28	63,67	62,91	70	-	25,0	25,0	-	0,4	
		22L075	TL75022	3F	F27	1108	28	66,70	65,94	75	-	25,0	25,0	-	0,4	
		23L075	TL75023	3F	F28	1108	28	69,73	68,97	79	-	25,0	25,0	-	0,4	
		24L075	TL75024	3F	F28	1108	28	72,77	72,00	79	-	25,0	25,0	-	0,5	
		25L075	TL75025	3F	F29	1108	28	75,80	75,04	83	-	25,0	25,0	-	0,6	
		26L075	TL75026	3F	F30	1108	28	78,83	78,07	87	-	25,0	25,0	-	0,6	
		27L075	TL75027	3F	F30	1108	28	81,86	81,10	87	-	25,0	25,0	-	0,7	
		28L075	TL75028	3F	F31	1108	28	84,89	84,13	91	-	25,0	25,0	-	0,7	
		30L075	TL75030	3F	F33	1108	28	90,96	90,20	97	-	25,0	25,0	-	0,9	
		32L075	TL75032	3F	F34	1108	28	97,02	96,26	102	-	25,0	25,0	-	1,0	
		36L075	TL75036	3F	F37	1610	42	109,15	108,39	115	-	25,0	25,0	-	1,2	
		40L075	TL75040	3F	F40	1610	42	121,28	120,51	128	-	25,0	25,0	-	1,7	
Ghisa / Cast iron Grauguss / Fonte Hierro fundido	senza flangia without flanges ohne Flanschen sans flasques sin tapetas	44L075	TL75044	3WF	F45	1610	42	133,40	132,64	142	90	110	25,0	25,0	-	2,1
		48L075	TL75048	3WF	F48	1610	42	145,53	144,77	150	92	120	25,0	25,0	-	2,5
		60L075	TL75060	3W		1610	42	181,91	181,15	-	92	166	25,0	25,0	-	3,0
		72L075	TL75072	3A		1610	42	218,30	217,53	-	92	202	25,0	25,0	-	4,0
		84L075	TL75084	7A		2012	50	254,68	253,90	-	92	236	25,0	32,0	-	5,2
		96L075	TL75096	7A		2012	50	291,06	290,30	-	106	270	25,0	32,0	3,5	6,5
		120L075	TL75120	7A		2012	50	363,83	363,07	-	106	343	25,0	32,0	3,5	7,6

L 100 - 3/8" (9,525 mm)

Caratteristiche Features Merkmale Características	Codice Code symbol Fabriknummer Code symbole Numero de fabrica	Nostro codice Our code Unser kode Notre code Nuestro codigito	Tipo Type Typ Type Tipo	Tipo flangia Flanges type Bordscheiben Typ Type flasques Tipo tapetas	Bussola Bush Buchse Moyeu Casquillo	Foro max. Max. Bore Max. Bohrung Alesage max. Agujero max.	Dp	De	Df	Dm	Di	F	S	R	Peso Weight / Gewicht Poids / Peso Kg	
Acciaio / Steel / Stahl Acier / Acero	con flangia / with flanges mit Flanges / avec flasques / con tapetas	18L100	TL10018	5F	F22	1108	28	54,57	53,81	60	-	38	31,0	22,0	9,0	0,2
		19L100	TL10019	5F	F24	1108	28	57,61	56,84	64	-	38	31,0	22,0	9,0	0,3
		20L100	TL10020	5F	F25	1108	28	60,64	59,88	66	-	45	31,0	22,0	9,0	0,4
		21L100	TL10021	5F	F26	1108	28	63,67	62,91	70	-	45	31,0	22,0	9,0	0,4
		22L100	TL10022	5F	F27	1108	28	66,70	65,94	75	-	48	31,0	22,0	9,0	0,4
		23L100	TL10023	5F	F28	1108	28	69,73	68,97	79	-	52	32,0	22,0	10,0	0,5
		24L100	TL10024	5F	F28	1108	28	72,77	72,00	79	-	52	32,0	22,0	10,0	0,6
		25L100	TL10025	5F	F29	1108	28	75,80	75,04	83	-	54	32,0	22,0	10,0	0,6
		26L100	TL10026	5F	F30	1108	28	78,83	78,07	87	-	60	32,0	22,0	10,0	0,7
		27L100	TL10027	5F	F30	1108	28	81,86	81,10	91	-	60	32,0	22,0	10,0	0,8
		28L100	TL10028	5F	F31	1108	28	84,89	84,13	91	-	65	32,0	22,0	10,0	0,8
		30L100	TL10030	5F	F33	1210	32	90,96	90,20	97	-	71	32,0	25,0	7,0	0,9
		32L100	TL10032	5F	F34	1210	32	97,02	96,26	102	-	75	32,0	25,0	7,0	1,0
		36L100	TL10036	5F	F37	1610	42	109,15	108,39	115	-	86	32,0	25,0	7,0	1,4
		40L100	TL10040	5F	F40	1610	42	121,28	120,51	128	-	96	32,0	25,0	7,0	1,7
Ghisa / Cast iron Grauguss / Fonte Hierro fundido	senza flangia without flanges ohne Flanschen sans flasques sin tapetas	44L100	TL10044	5WF	F45	1610	42	133,40	132,64	142	90	110	32,0	25,0	-	2,3
		48L100	TL10048	5WF	F48	1610	42	145,53	144,77	150	92	120	32,0	25,0	7,0	2,7
		60L100	TL10060	9W		1610	42	181,91	181,15	-	92	166	32,0	25,0	3,5	2,4
		72L100	TL10072	3A		2012	50	218,30	217,53	-	92	202	32,0	32,0	-	4,4
		84L100	TL10084	3A		2012	50	254,68	253,90	-	92	236	32,0	32,0	-	6,0
		96L100	TL10096	3A		2012	50	291,06	290,30	-	106	270	32,0	32,0	-	7,1
120L100	TL10120	3A		2012	50	363,83	363,07	-	106	343	32,0	32,0	-	8,5		

Pulegge dentate per bussola conica / Timing belt pulleys for taper bushes
Zahnriemenscheiben für Spannbüchsen / Poulies dentées à moyeu amovible
Poleas dentadas para casquillos cónicos (taper)



H 100 - 1/2" (12,7 mm)

Caratteristiche Features Merkmale Características	Codice Code symbol Fabriknummer Code symbole Numero de fabrica	Nostro codice Our code Unser kode Notre code Nuestro codigo	Tipo Type Typ Type Tipo	Tipo flangia Flanges type Bordscheiben Typ Type flasques Tipo tapetas	Bussola Bush Buchse Moyeu Casquillo	Foro max. Max. Bore Max. Bohrung Alesage max. Agujero max.	Dp	De	Df	Dm	Di	F	S	R	Peso Weight / Gewicht Poids / Peso Kg	
Acciaio / Steel / Stahl Acier / Acero	con flangia / with flanges mit Flanges / avec flasques / con tapetas	16H100	TH10016	5F	F26	1108	28	64,68	63,31	70	-	45	31,0	22,0	9,0	0,4
		18H100	TH10018	5F	F28	1210	32	72,77	71,39	79	-	52	31,0	25,0	6,0	0,5
		19H100	TH10019	5F	F29	1210	32	76,81	75,44	83	-	56	31,0	25,0	6,0	0,6
		20H100	TH10020	5F	F30	1210	32	80,55	79,48	87	-	60	31,0	25,0	6,0	0,7
		21H100	TH10021	5F	F31	1210	32	84,89	83,52	91	-	64	32,0	25,0	7,0	0,8
		22H100	TH10022	5F	F32	1210	32	88,94	87,56	93	-	67	32,0	25,0	7,0	0,9
		23H100	TH10023	5F	F33	1610	42	92,98	91,61	97	-	70	32,0	25,0	7,0	0,9
		24H100	TH10024	5F	F34	1610	42	97,02	95,65	102	-	74	32,0	25,0	7,0	1,0
		25H100	TH10025	5F	F35	1610	42	101,06	99,69	106	-	77	32,0	25,0	7,0	1,0
		26H100	TH10026	5F	F36	1610	42	105,11	103,73	112	-	82	32,0	25,0	7,0	1,2
		27H100	TH10027	5F	F37	1610	42	109,15	107,78	115	-	85	32,0	25,0	7,0	1,3
		28H100	TH10028	5F	F38	1610	42	113,19	111,82	120	-	90	32,0	25,0	7,0	1,5
		30H100	TH10030	5F	F40	1610	42	121,28	119,90	128	-	98	32,0	25,0	7,0	1,7
		32H100	TH10032	5WF	F42	1610	42	129,36	127,99	135	80	106	32,0	25,0	7,0	2,0
		36H100	TH10036	5WF	F48	1610	42	145,53	144,16	150	92	121	32,0	25,0	7,0	2,7
		40H100	TH10040	5WF	F52	1610	42	161,70	160,33	168	92	138	32,0	25,0	7,0	3,6
44H100	TH10044	3WF	F55	2012	50	177,87	176,50	184	106	152	32,0	32,0	-	3,8		
48H100	TH10048	3WF	F59	2012	50	194,04	192,67	200	106	169	32,0	32,0	-	3,2		
Ghisa / Cast iron Grauguss / Fonte Hierro fundido	senza flangia without flanges ohne Flanschen sans flasques sin tapetas	60H100	TH10060	9A		2012	50	242,55	241,18	-	92	223	34,0	32,0	1,0	4,8
		72H100	TH10072	9A		2012	50	291,06	289,69	-	92	270	34,0	32,0	1,0	5,7
		84H100	TH10084	9A		2012	50	339,57	338,20	-	92	318	34,0	32,0	1,0	6,8
		96H100	TH10096	7A		2517	60	388,08	386,71	-	106	366	34,0	45,0	5,5	8,2
		120H100	TH10120	7A		2517	60	485,10	483,73	-	106	462	34,0	45,0	5,5	12,1

H 150 - 1/2" (12,7 mm)

Caratteristiche Features Merkmale Características	Codice Code symbol Fabriknummer Code symbole Numero de fabrica	Nostro codice Our code Unser kode Notre code Nuestro codigo	Tipo Type Typ Type Tipo	Tipo flangia Flanges type Bordscheiben Typ Type flasques Tipo tapetas	Bussola Bush Buchse Moyeu Casquillo	Foro max. Max. Bore Max. Bohrung Alesage max. Agujero max.	Dp	De	Df	Dm	Di	F	S	R	Peso Weight / Gewicht Poids / Peso Kg	
Acciaio / Steel / Stahl Acier / Acero	con flangia / with flanges mit Flanges / avec flasques / con tapetas	18H150	TH15018	5F	F28	1210	32	72,77	71,39	79	-	52	45,0	25,0	20,0	0,6
		19H150	TH15019	5F	F29	1210	32	76,81	75,44	83	-	56	45,0	25,0	20,0	0,7
		20H150	TH15020	5F	F30	1210	32	80,55	79,48	87	-	60	45,0	25,0	20,0	0,8
		21H150	TH15021	5F	F31	1210	32	84,89	83,52	91	-	64	45,0	25,0	20,0	1,0
		22H150	TH15022	5F	F32	1210	32	88,94	87,56	93	-	67	45,0	25,0	20,0	1,2
		23H150	TH15023	5F	F33	1610	42	92,98	91,61	97	-	70	45,0	25,0	20,0	1,3
		24H150	TH15024	5F	F34	1610	42	97,02	95,65	102	-	74	45,0	25,0	20,0	1,0
		25H150	TH15025	5F	F35	1610	42	101,06	99,69	106	-	77	45,0	25,0	20,0	1,2
		26H150	TH15026	5F	F36	1610	42	105,11	103,73	112	-	82	45,0	25,0	20,0	1,4
		27H150	TH15027	5F	F37	1610	42	109,15	107,78	115	-	85	45,0	25,0	20,0	1,6
		28H150	TH15028	5F	F38	1610	42	113,19	111,82	120	-	90	45,0	25,0	20,0	1,8
		30H150	TH15030	5F	F40	1610	42	121,28	119,90	128	-	98	45,0	25,0	20,0	2,3
		32H150	TH15032	5WF	F42	1610	42	129,36	127,99	135	80	106	45,0	25,0	20,0	2,3
		36H150	TH15036	5WF	F48	1610	42	145,53	144,16	150	92	121	45,0	25,0	20,0	3,1
		40H150	TH15040	5WF	F52	1610	42	161,70	160,33	168	92	138	45,0	25,0	20,0	4,0
		44H150	TH15044	5WF	F55	2012	50	177,87	176,50	184	106	152	45,0	32,0	13,0	4,4
48H150	TH15048	5WF	F59	2012	50	194,04	192,67	200	106	169	45,0	32,0	13,0	4,8		
Ghisa / Cast iron Grauguss / Fonte Hierro fundido	senza flangia without flanges ohne Flanschen sans flasques sin tapetas	60H150	TH15060	9A		2012	50	242,55	241,18	-	92	223	46,0	32,0	7,5	5,4
		72H150	TH15072	9A		2012	50	291,06	289,69	-	92	270	46,0	32,0	7,5	6,5
		84H150	TH15084	9A		2012	50	339,57	338,20	-	92	318	46,0	32,0	7,5	8,4
		96H150	TH15096	9A		2517	60	388,08	386,71	-	106	366	46,0	45,0	0,5	11,0
		120H150	TH73120	9A		2517	60	485,10	483,73	-	106	462	46,0	45,0	0,5	14,8

Pulegge dentate per bussola conica / Timing belt pulleys for taper bushes
Zahnriemenscheiben für Spannbüchsen / Poulies dentées à moyeu amovible
Poleas dentadas para casquillos cónicos (taper)

H 200 - 1/2" (12,7 mm)

Caratteristiche Features Merkmal Características	Codice Code symbol Fabriknummer Code symbole Numero de fabrica	Nostro codice Our code Unser kode Notre code Nuestro codigo	Tipo Type Typ Type Tipo	Tipo flangia Flanges type Bordscheiben Typ Type flasques Tipo tapetas	Bussola Bush Buchse Moyeu Casquillo	Foro max. Max. Bore Max. Bohrung Alesage max. Agujero max.	Dp	De	Df	Dm	Di	F	S	R	Peso Weight / Gewicht Poids / Peso Kg	
Acciaio / Steel / Stahl Acier / Acero	con flangia / with flanges mit Flanges / avec flasques / con tapetas	18H200	TH20018	5F	F28	1210	32	72,77	71,39	79	-	52	58,0	25,0	33,0	0,8
		19H200	TH20019	5F	F29	1210	32	76,81	75,44	83	-	56	58,0	25,0	33,0	0,9
		20H200	TH20020	5F	F30	1610	42	80,55	79,48	87	-	60	58,0	25,0	33,0	1,0
		21H200	TH20021	5F	F31	1610	42	84,89	83,52	91	-	64	58,0	25,0	33,0	1,7
		22H200	TH20022	5F	F32	1610	42	88,94	87,56	93	-	67	58,0	25,0	33,0	1,5
		23H200	TH20023	5F	F33	1610	42	92,98	91,61	97	-	70	58,0	25,0	33,0	1,8
		24H200	TH20024	5F	F34	1610	42	97,02	95,65	102	-	74	58,0	25,0	33,0	1,5
		25H200	TH20025	5F	F35	1610	42	101,06	99,69	106	-	77	58,0	25,0	33,0	1,5
		26H200	TH20026	5F	F36	1610	42	105,11	103,73	112	-	82	58,0	25,0	33,0	1,8
		27H200	TH20027	5F	F37	1610	42	109,15	107,78	115	-	85	58,0	25,0	33,0	1,9
		28H200	TH20028	5F	F38	1610	42	113,19	111,82	120	-	90	58,0	25,0	33,0	1,9
		30H200	TH20030	5F	F40	1610	42	121,28	119,90	128	-	98	58,0	25,0	33,0	2,3
		32H200	TH20032	5F	F42	2012	50	129,36	127,99	135	-	106	58,0	32,0	26,0	3,0
		36H200	TH20036	5WF	F48	2012	50	145,53	144,16	150	102	121	58,0	32,0	26,0	3,0
		40H200	TH20040	5WF	F52	2012	50	161,70	160,33	168	106	140	58,0	32,0	26,0	3,6
		44H200	TH20044	5WF	F55	2012	50	177,87	176,50	184	106	150	58,0	32,0	26,0	4,0
48H200	TH20048	5WF	F59	2517	60	194,04	192,67	200	119	168	58,0	45,0	13,0	4,6		
Ghisa / Cast iron Grauguss / Fonte Hierro fundido	senza flangia without flanges ohne Flanschen sans flasques sin tapetas	60H200	TH20060	9A		2517	60	242,55	241,18	-	119	223	60,0	45,0	7,5	7,0
		72H200	TH20072	9A		2517	60	291,06	289,69	-	119	270	60,0	45,0	7,5	8,0
		84H200	TH20084	9A		2517	60	339,57	338,20	-	119	318	60,0	45,0	7,5	9,0
		96H200	TH20096	9A		2517	60	388,08	386,71	-	119	366	60,0	45,0	7,5	10,0
		120H200	TH20120	9A		2517	60	485,10	483,73	-	119	462	60,0	45,0	7,5	13,4

H 300 - 1/2" (12,7 mm)

Caratteristiche Features Merkmal Características	Codice Code symbol Fabriknummer Code symbole Numero de fabrica	Nostro codice Our code Unser kode Notre code Nuestro codigo	Tipo Type Typ Type Tipo	Tipo flangia Flanges type Bordscheiben Typ Type flasques Tipo tapetas	Bussola Bush Buchse Moyeu Casquillo	Foro max. Max. Bore Max. Bohrung Alesage max. Agujero max.	Dp	De	Df	Dm	Di	F	S	R	Peso Weight / Gewicht Poids / Peso Kg	
Acciaio / Steel / Stahl Acier / Acero	con flangia / with flanges mit Flanges / avec flasques / con tapetas	20H300	TH30020	4F	F31	1615	42	80,85	79,48	87	-	65	84,0	38,0	23,0	1,5
		21H300	TH30021	4F	F31	1615	42	84,89	83,52	91	-	65	84,0	38,0	23,0	1,2
		22H300	TH30022	4F	F32	1615	42	88,94	87,56	93	-	67	84,0	38,0	23,0	1,6
		23H300	TH30023	4F	F33	1615	42	92,98	91,61	97	-	70	84,0	38,0	23,0	1,8
		24H300	TH30024	4F	F34	1615	42	97,02	95,65	102	-	74	84,0	38,0	23,0	2,0
		25H300	TH30025	4F	F35	1615	42	101,06	99,69	106	-	77	84,0	38,0	23,0	2,0
		26H300	TH30026	4F	F36	1615	42	105,11	103,73	112	-	82	84,0	38,0	23,0	2,7
		27H300	TH30027	4F	F37	2012	50	109,15	107,78	115	-	85	84,0	32,0	26,0	3,0
		28H300	TH30028	4F	F38	2012	50	113,19	111,82	120	-	90	84,0	32,0	26,0	2,4
		30H300	TH30030	4F	F40	2012	50	121,28	119,90	128	-	98	84,0	32,0	26,0	2,9
		32H300	TH30032	4F	F42	2517	60	129,36	127,99	135	-	106	84,0	45,0	19,5	3,3
		36H300	TH30036	4F	F48	2517	60	145,53	144,16	150	-	121	84,0	45,0	19,5	4,5
		40H300	TH30040	4F	F52	2517	60	161,70	160,33	168	-	138	84,0	45,0	19,5	6,0
		44H300	TH30044	4WF	F55	2517	60	177,87	176,50	184	119	150	86,0	45,0	20,5	6,6
		48H300	TH30048	4WF	F59	2517	60	194,04	192,67	200	119	168	86,0	45,0	20,5	7,6
		Ghisa / Cast iron Grauguss / Fonte Hierro fundido	senza flangia without flanges ohne Flanschen sans flasques sin tapetas	60H300	TH30060	9A		2517	60	242,55	241,18	-	119	223	86,0	45,0
72H300	TH30072			9A		2517	60	291,06	289,69	-	119	270	86,0	45,0	20,5	10,4
84H300	TH30084			9A		2517	60	339,57	338,20	-	119	318	86,0	45,0	20,5	12,5
96H300	TH30096			9A		3030	75	388,08	386,71	-	150	366	86,0	76,0	5,0	14,2
120H300	TH30120			9A		3030	75	485,10	483,73	-	150	462	86,0	76,0	5,0	18,8

Pulegge dentate per bussola conica / Timing belt pulleys for taper bushes
Zahnriemenscheiben für Spannbüchsen / Poulies dentées à moyeu amovible
Poleas dentadas para casquillos cónicos (taper)



XH 200 - 7/8" (22,225 mm)

Caratteristiche Features Merkmale Características	Codice Code symbol Fabriknummer Code symbole Numero de fabrica	Nostro codice Our code Unser kode Notre code Nuestro codigoo	Tipo Type Typ Type Tipo	Tipo flangia Flanges type Bordscheiben Typ Type flasques Tipo tapetas	Bussola Bush Buchse Moyeu Casquillo	Foro max. Max. Bore Max. Bohrung Alesage max. Agujero max.	Dp	De	Df	Dm	Di	F	S	R	Peso Weight / Gewicht Poids / Peso Kg
Ghisa / Cast iron Grauguss / Fonte Hierro fundido	con flangia / with flanges mit Flanges / avec flasques / con tapetas	18XH200	TXH2018	5F	F44	2517	60	127,34	124,55	140	-	95	64	45	19,0
		20XH200	TXH2020	5F	F49	2517	60	141,49	138,69	154	-	110	64	45	19,0
		22XH200	TXH2022	5F	F52	2517	60	155,64	152,84	168	-	120	64	45	19,0
		24XH200	TXH2024	5F	F55	2517	60	169,79	166,99	184	-	135	64	45	19,0
		26XH200	TXH2026	5F	F59	2517	60	183,94	181,14	200	-	150	64	45	19,0
		28XH200	TXH2028	4WF	F61	2517	60	198,08	195,29	212	120	165	64	45	9,5
		30XH200	TXH2030	4WF	F62	2517	60	212,23	209,44	226	120	180	64	45	9,5
		32XH200	TXH2032	4WF	F64	2517	60	226,38	223,59	240	120	195	64	45	9,5
		40XH200	TXH2040	4WF	F70	3020	75	282,98	280,18	296	160	245	64	51	9,5
	senza flangia / without flanges ohne Flanschen / sans flasques sin tapetas	48XH200	TXH2048	9W		3020	75	339,57	336,78	-	160	300	64	51	6,5
		60XH200	TXH2060	7A		3535	90	424,47	421,67	-	190	385	64	89	12,5
		72XH200	TXH2072	7A		3535	90	509,40	506,56	-	190	470	64	89	12,5
		84XH200	TXH2084	7A		3535	90	594,25	591,46	-	190	555	64	89	12,5
		96XH200	TXH2096	7A		3535	90	679,15	676,35	-	190	640	64	89	12,5
		120XH200	TXH2120	7A		3535	90	848,93	846,14	-	190	810	64	89	12,5

XH 300 - 7/8" (22,225 mm)

Caratteristiche Features Merkmale Características	Codice Code symbol Fabriknummer Code symbole Numero de fabrica	Nostro codice Our code Unser kode Notre code Nuestro codigoo	Tipo Type Typ Type Tipo	Tipo flangia Flanges type Bordscheiben Typ Type flasques Tipo tapetas	Bussola Bush Buchse Moyeu Casquillo	Foro max. Max. Bore Max. Bohrung Alesage max. Agujero max.	Dp	De	Df	Dm	Di	F	S	R	Peso Weight / Gewicht Poids / Peso Kg
Ghisa / Cast iron Grauguss / Fonte Hierro fundido	con flangia / with flanges mit Flanges / avec flasques / con tapetas	18XH300	TXH3018	5F	F44	2517	60	127,34	124,55	140	-	95	90	45	45,0
		20XH300	TXH3020	5F	F49	2517	60	141,49	138,69	154	-	110	90	45	45,0
		22XH300	TXH3022	5F	F52	2517	60	155,64	152,84	168	-	120	90	45	45,0
		24XH300	TXH3024	5F	F55	2517	60	169,79	166,99	184	-	135	90	45	45,0
		26XH300	TXH3026	5F	F59	2517	60	183,94	181,14	200	-	150	90	45	45,0
		28XH300	TXH3028	5F	F61	3020	75	198,08	195,29	212	120	165	90	51	39,0
		30XH300	TXH3030	5F	F62	3020	75	212,23	209,44	226	120	180	90	51	39,0
		32XH300	TXH3032	5F	F64	3020	75	226,38	223,59	240	120	195	90	51	39,0
		40XH300	TXH3040	4WF	F70	3020	75	282,98	280,18	296	160	245	90	51	19,5
	senza flangia / without flanges ohne Flanschen / sans flasques sin tapetas	48XH300	TXH3048	9A		3020	75	339,57	336,78	-	160	300	90	51	19,5
		60XH300	TXH3060	9A		3535	90	424,47	421,67	-	190	385	90	89	0,5
		72XH300	TXH3072	9A		3535	90	509,40	506,56	-	190	470	90	89	0,5
		84XH300	TXH3084	7A		4040	100	594,25	591,46	-	190	555	90	102	6,0
		96XH300	TXH3096	7A		4040	100	679,15	676,35	-	190	640	90	102	6,0
		120XH300	TXH3120	7A		4040	100	848,93	846,14	-	190	810	90	102	6,0

XH 400 - 7/8" (22,225 mm)

Caratteristiche Features Merkmale Características	Codice Code symbol Fabriknummer Code symbole Numero de fabrica	Nostro codice Our code Unser kode Notre code Nuestro codigo	Tipo Type Typ Type Tipo	Tipo flangia Flanges type Bordscheiben Typ Type flasques Tipo tapetas	Bussola Bush Buchse Moyeu Casquillo	Foro max. Max. Bore Max. Bohrung Alesage max. Agujero max.	Dp	De	Df	Dm	Di	F	S	R	Peso Weight / Gewicht Poids / Peso Kg
Ghisa / Cast iron Grauguss / Fonte Hierro fundido	con flangia / with flanges mit Flanges / avec flasques / con tapetas	18XH400	TXH4018	5F	F44	2517	60	127,34	124,55	140	-	95	119	45	74,0
		20XH400	TXH4020	5F	F49	2517	60	141,49	138,69	154	-	110	119	45	74,0
		22XH400	TXH4022	5F	F52	2517	60	155,64	152,84	168	-	120	119	45	74,0
		24XH400	TXH4024	5F	F55	3020	75	169,79	166,99	184	-	135	119	51	68,0
		26XH400	TXH4026	5F	F59	3020	75	183,94	181,14	200	-	150	119	51	68,0
		28XH400	TXH4028	5F	F61	3020	75	198,08	195,29	212	120	165	119	51	68,0
		30XH400	TXH4030	5F	F62	3020	75	212,23	209,44	226	120	180	119	51	68,0
		32XH400	TXH4032	5F	F64	3020	75	226,38	223,59	240	120	195	119	51	68,0
		40XH400	TXH4040	4WF	F70	3535	90	282,98	280,18	296	160	245	119	89	15,0
	senza flangia / without flanges ohne Flanschen / sans flasques sin tapetas	48XH400	TXH4048	9W		3535	90	339,57	336,78	-	160	300	119	89	15,0
		60XH400	TXH4060	9A		4040	100	424,47	421,67	-	190	385	119	102	8,5
		72XH400	TXH4072	9A		4040	100	509,40	506,56	-	190	470	119	102	8,5
		84XH400	TXH4084	9A		4040	100	594,25	591,46	-	190	555	119	102	8,5
		96XH400	TXH4096	9A		4040	100	679,15	676,35	-	190	640	119	102	8,5
		120XH400	TXH4120	9A		4040	100	848,93	846,14	-	190	810	119	102	8,5