

KEYWAY DIMENSIONS DIN 6885/1

d	b P9	h	t2	t4
from 6 to 8	2	2	1 ^{+0.1}	1.2 ^{+0.1}
> 8 to 10	3	3	1.4 ^{+0.1}	1.8 ^{+0.1}
> 10 to 12	4	4	1.8 ^{+0.1}	2.5 ^{+0.1}
> 12 to 17	5	5	2.3 ^{+0.1}	3 ^{+0.1}
> 17 to 22	6	6	2.8 ^{+0.1}	3.5 ^{+0.1}
> 22 to 30	8	7	3.3 ^{+0.2}	4 ^{+0.2}
> 30 to 38	10	8	3.3 ^{+0.2}	5 ^{+0.2}
> 38 to 44	12	8	3.3 ^{+0.2}	5 ^{+0.2}
> 44 to 50	14	9	3.8 ^{+0.2}	5.5 ^{+0.2}

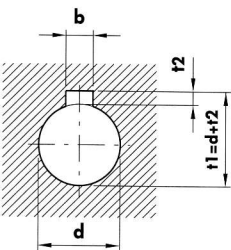

DIN 6885/1

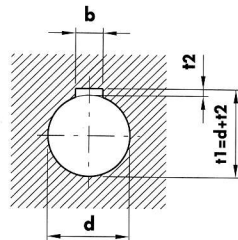
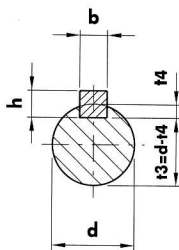

DIN 6885/2

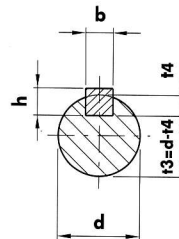

KEYWAY DIMENSIONS DIN 6885/2

d	b P9	h	t2	t4
> 10 to 12	4	4	1.1 ^{+0.1}	3 ^{+0.1}
> 12 to 17	5	5	1.3 ^{+0.1}	3.8 ^{+0.1}
> 17 to 22	6	6	1.7 ^{+0.1}	4.4 ^{+0.1}
> 22 to 30	8	7	1.7 ^{+0.2}	5.4 ^{+0.2}
> 30 to 38	10	8	2.1 ^{+0.2}	6 ^{+0.2}
> 38 to 44	12	8	2.1 ^{+0.2}	6 ^{+0.2}
> 44 to 50	14	9	2.6 ^{+0.2}	6.5 ^{+0.2}